



GRAPH-I-CELL



DESCRIPTION

Fitted with a dome shaped opaline diffuser for a sharp image rendition and an optimal peripheral visibility, this high brightness single pixel fixture can be easily assembled with other units of its kind to screen low-resolution video files and graphic patterns in coloured and white light. GRAPH-I-CELL can be integrated with the existing architecture while shaping a brand new outstanding ambience.

MAIN FEATURES

- Max. delivered lm output: 630 lm / 48 lm/W
- Size: (HxWxD) 130x128x91 mm / 5.1x5x3.6"
- Control system: DMX, self-addressing
- High brightness single pixel fixture for the creation of multiple graphic patterns and low resolution video files on large scale façades

LED COLOUR CONFIGURATIONS



GRAPH-I-CELL

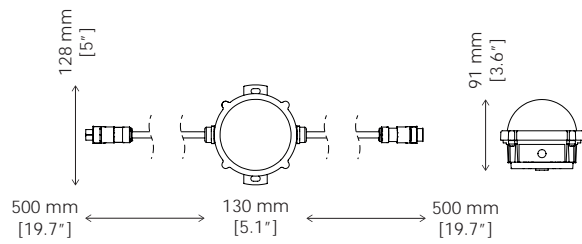

FEATURES



OPTIONS



LED COLOUR CONFIGURATIONS

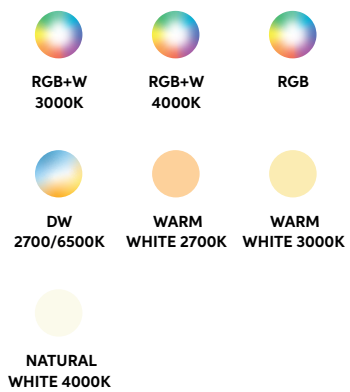

FINISHES

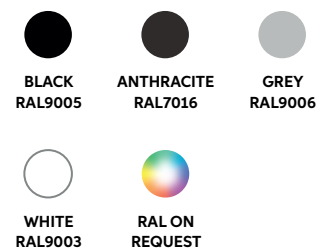

MORE INFO



CODES

AL4505 GRAPH-I-CELL 3
AL4506 GRAPH-I-CELL 4

PERFORMANCE

	WATT	MAX LM OUTPUT	LM WATT
GRAPH-I-CELL 3 RGB	13	494	38
GRAPH-I-CELL 4 RGBW	13	630	48

PIXEL PITCH

GRAPH-I-CELL (all versions) 130 mm (min.)

BEAM ANGLE REFERENCE

OPALINE DOME 124°



Vietnam – Cua Luc 1 Bridge, Ha Long